

FAG

6201-H

Deep groove ball bearing

Schaeffler ID:
0937950760000Deep groove ball bearing 62..-H, single
row, H-Series, steel sheet metal cage

Technical information

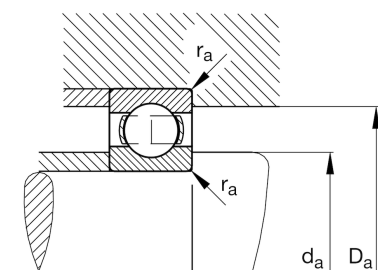
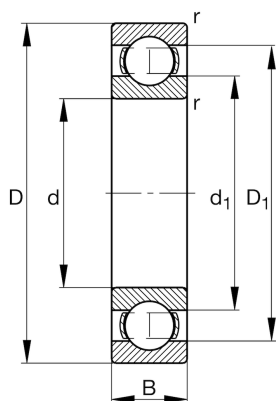
**Main Dimensions & Performance Data**

d	12 mm	Bore diameter
D	32 mm	Outside diameter
B	10 mm	Width
C_r	7.280 N	Basic dynamic load rating, radial
C_{0r}	3.100 N	Basic static load rating, radial
C_{ur}	179 N	Fatigue load limit, radial
n_G	33.500 1/min	Limiting speed
n_{gr}	21.900 1/min	Reference speed
	0,037 kg	Weight

Dimensions

r_{min}	0,6 mm	Minimum chamfer dimension
D_1	26,1 mm	Shoulder diameter outer ring
d_1	18,3 mm	Shoulder diameter inner ring

Mounting dimensions

$d_{a min}$	16,2 mm	Minimum diameter shaft shoulder
$D_{a max}$	27,8 mm	Maximum diameter of housing shoulder
$r_{a max}$	0,6 mm	Maximum fillet radius

Calculation factors

f_0	12,5	Calculation factor
-------	------	--------------------

Temperature range

T_{min}	-30 °C	Operating temperature min.
T_{max}	120 °C	Operating temperature max.